



---

**VERTICAL FIXING KIT**  
**INSTRUCTION MANUAL**

---

**The Sail Loft, Unit 16, Sandford Lane Industrial Estate, Wareham, Dorset BH20 4DY**

Phone: +44 (0)1929 554308  
[www.shade-solutions.com](http://www.shade-solutions.com)



Email: [info@kempsails.com](mailto:info@kempsails.com)  
[www.kempsails.com](http://www.kempsails.com)

The vertical fixing kits are our more refined adjustable rope kit. The kit has 3 spliced pieces of rope, splicing the rope to fixings (as shown below). The pulley system on this kit runs vertically down your post / wall, which allows for the Shade Sail to be tensioned closer to your desired anchorage point, whilst also providing a connection that can be attached and removed more easily. This means that this kit is suitable for Shades that are being erected on a daily basis.

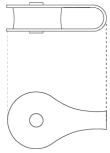

1 x Pulley Block 2 (*PLAIN BLOCK*)  
ATTACHED TO ROPE 2  
KSFXT2

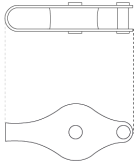

1 x Pulley Block 1 (*WITH BECKETT*)  
ATTACHED TO ROPE 1  
KSFXT1

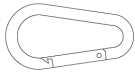

1 x Carbine Hook  
KSFXT9060

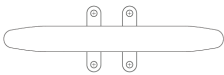

1 x Cross End Cleat  
KSFXT414D

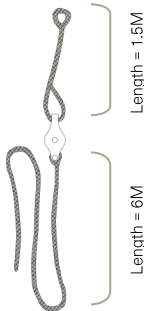

Length = 6M



Length = 1.5M

330mm finished inc. pulley

3 x 6mm Braided Rope

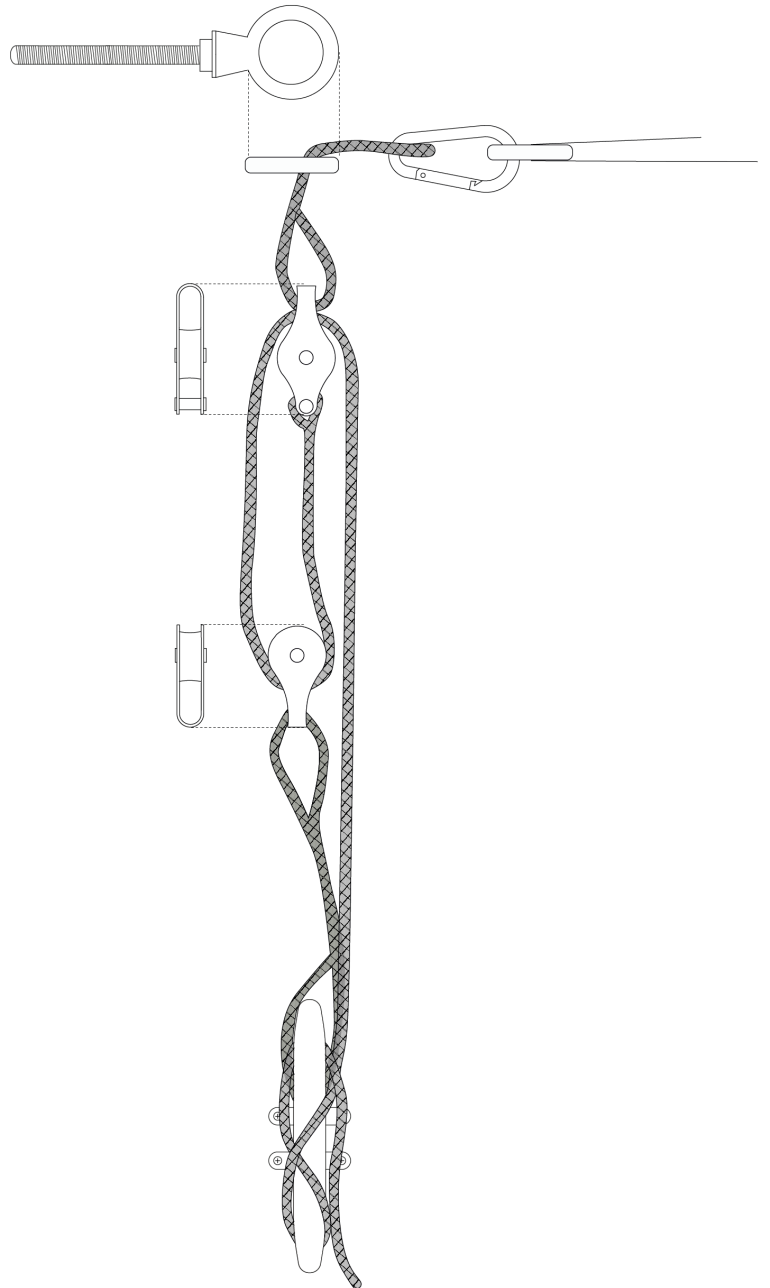

CORDLESS DRILL



HANDHELD PLIERS



SCREW DRIVER



**-STEP 1-**

Thread rope 1 through anchorage fixing and attach carabine hook to loop, holding the rope in place.

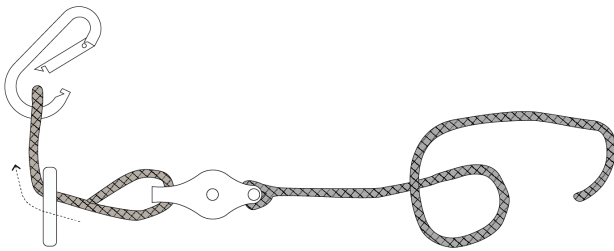

**-STEP 2-**

Thread block 2 onto rope one. Then take end of rope one back up and through pulley.

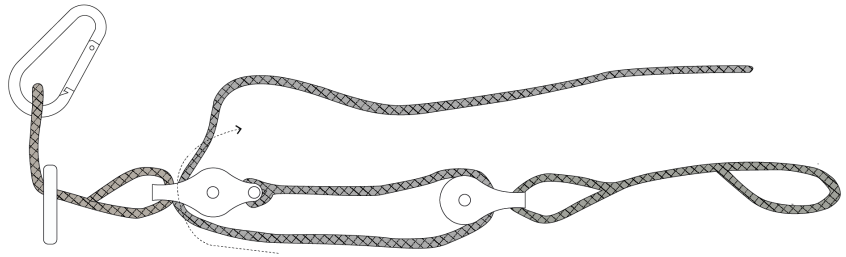

**-STEP 3-**

Fix cross end cleat to chosen point trapping loop on rope 2 between cleat and surface.

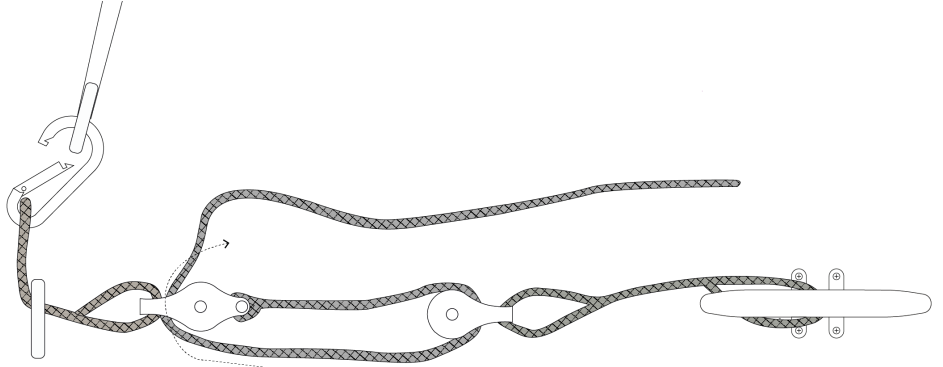

4 X ↑

**-STEP 4-**

Secure Shade Sail to carabine hook, then pull on loose end of rope 1 to tension shade. Secure in a figure of 8 around cleat.

