



VERTICAL FIXING KIT
KSFx60VPL
INSTRUCTION MANUAL

The Sail Loft, Unit 16, Sandford Lane Industrial Estate, Wareham, Dorset BH20 4DY

Phone: +44 (0)1929 554308
www.shade-solutions.com



Email: info@kempsails.com
www.kempsails.com

The vertical fixing kits are our more refined adjustable rope kit. The kit has 3 spliced lengths of rope, attached to pulleys as shown below. The pulley system on this kit runs vertically down your post or wall; the shade will sit closer to the post eye and can be erected or removed easily from ground level. This kit is suitable for smaller shades where ease of removal is required on a regular or even a daily basis.

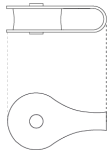

1 x Pulley Block 2 (*PLAIN BLOCK*)

ATTACHED TO ROPE 2
KSFXT2

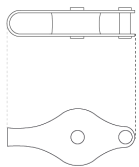

1 x Pulley Block 1 (*WITH BECKETT*)

ATTACHED TO ROPE 1
KSFXT1

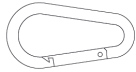

1 x Carbine Hook

KSFXT9060

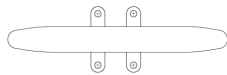

1 x Cross End Cleat

KSFXT414D

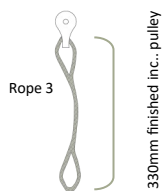
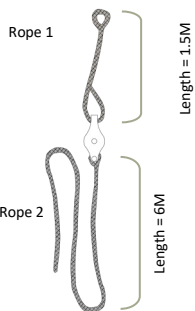

3 x 6mm Braided Rope

KSFXT5MWW

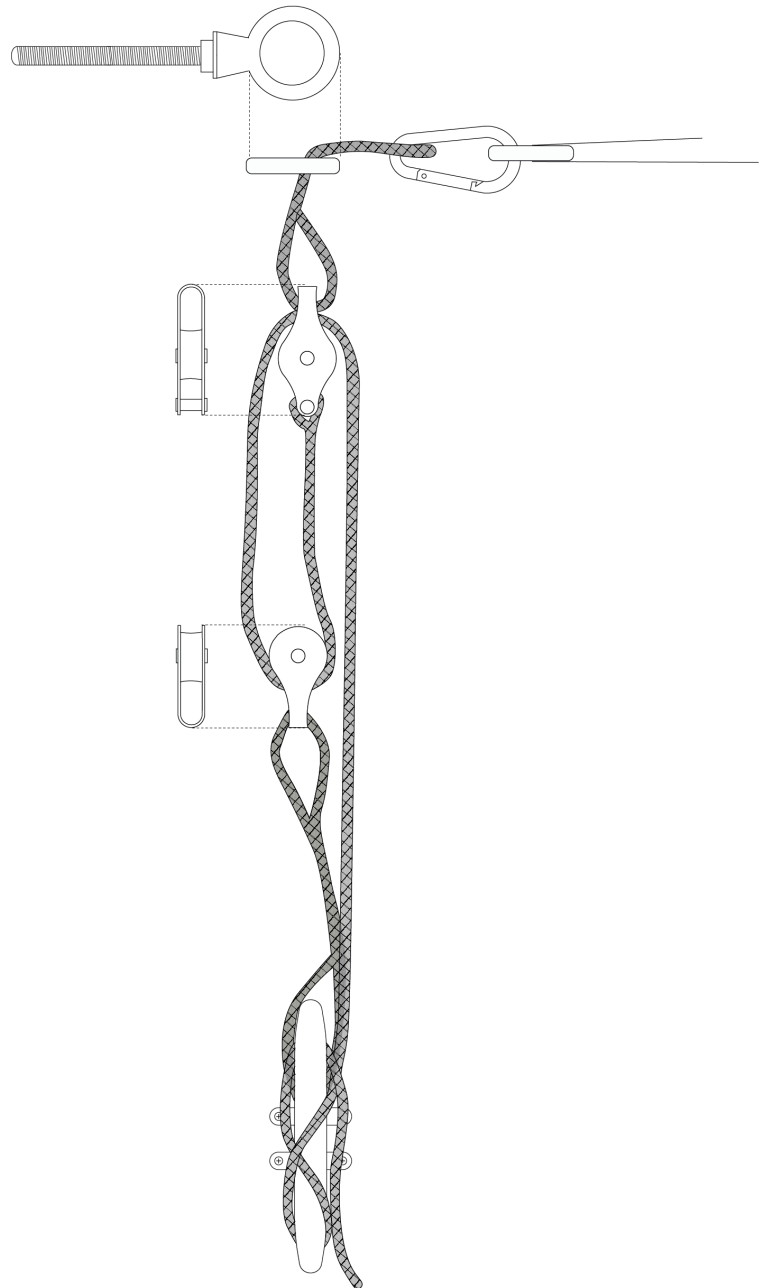



CORDLESS DRILL



HANDHELD PLIERS



SCREW DRIVER



-STEP 1-

Thread rope 1 through anchorage fixing and attach carabine hook to loop, holding the rope in place.

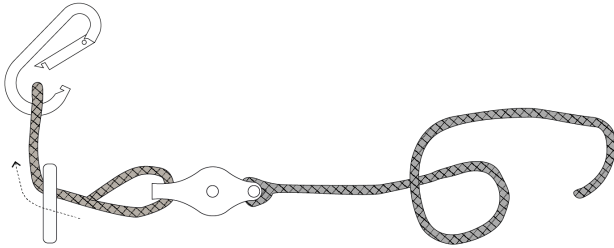

-STEP 2-

Thread block 2 onto rope one. Then take end of rope one back up and through pulley.

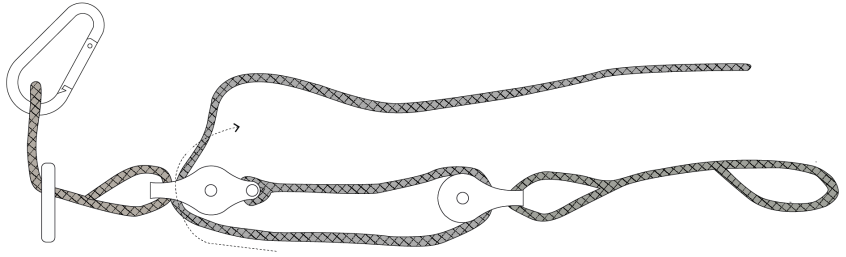

-STEP 3-

Fix cross end cleat to chosen point trapping loop on rope 2 between cleat and surface.

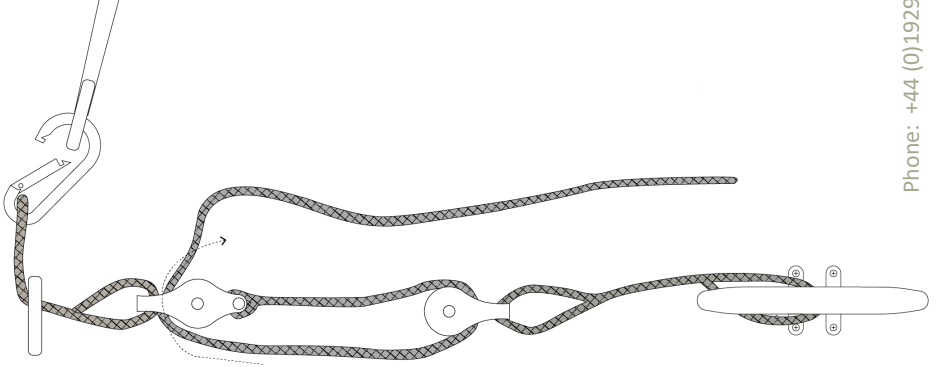

4 X ↑

-STEP 4-

Secure Shade Sail to carbine hook, then pull on loose end of rope 1 to tension shade. Secure in a figure of 8 around cleat.

